



**COFFEE MAKER**  
**OPERATING INSTRUCTIONS**

# EC-GAQ40 / EC-GAH40C

Thank you for your purchase of a ZOJIRUSHI product.  
Please read this Operating Instructions carefully for correct use.  
Please keep the Operating Instructions for future reference.

## INDEX

IMPORTANT SAFEGUARDS .....	2
PARTS NAMES .....	4
HOW TO USE .....	5
CLEANING AND MAINTENANCE .....	8
TROUBLESHOOTING GUIDE .....	10
REPLACEMENT PARTS .....	10
SPECIFICATIONS .....	10



# IMPORTANT SAFEGUARDS

## Before use

- These WARNINGS and CAUTIONS are intended to protect you and others from personal injury and household damage. To ensure safe operation, please follow carefully.

## WARNINGS

**Do not modify the product. Only a repair technician may disassemble or repair this unit.**

- Attempting to do so may cause fire, electric shock or injury. Make any repair inquiries to the store you purchased the product.

**Do not immerse the product in water or splash it with water.**

- Doing so may cause short circuit or electric shock.

**Do not plug or unplug the Power Cord if your hands are wet.**

- Doing so may cause electric shock or injury.

**Do not touch the Steam Vent or bring your hands or face near the Steam Vent.**

- Doing so may cause burns or scalding. Take special precautions with children and infants.

**Do not allow children to use the product unsupervised. Keep it out of the reach of infants.**

- Children are at risk of burns, electric shock or injury.

**Do not use a power source other than 220-230V (EC-GAQ40) or 220V (EC-GAH40C) AC.**

- Use of any other power supply voltage may cause fire or electric shock.

**Do not use this product without placing the Glass Jug.**

- It may cause scalding.

**Do not use the product if the Power Plug or Power Cord is damaged or if the Power Plug is loosely inserted into the electrical outlet.**

- Doing so may cause electric shock, short circuit or fire.

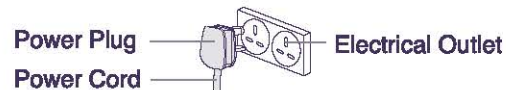

**Do not damage the Power Cord. Do not bend, pull, twist, fold, or attempt to modify the Power Cord. Do not place it on or near high temperature surfaces or appliances, under heavy items or between objects.**

- A damaged Power Cord can cause fire or electric shock.

**Insert the Power Plug completely and securely into the electrical outlet.**

- A loosely inserted Power Plug may cause electric shock, short circuit, smoke or fire.

**Use only an electrical outlet rated at 10 amperes minimum, and do not plug other devices into the same outlet.**

- Plugging other devices into the same outlet may cause the electrical outlet to overheat, resulting in fire.

**If the blades or surface of the Power Plug become soiled, wipe them clean.**

- A dirty Power Plug may cause fire.

**Stop using immediately if you notice any of the following symptoms indicating a malfunction or breakdown.**

Continued use of the product may cause smoke, fire, electric shock or injury.

- The Power Plug or Power Cord has become very hot.
- The Power Cord is deeply damaged or deformed.
- There is a burning smell.
- Some part of the product is cracked, unstable or loose.
- The electricity turns on and off when the Power Cord is touched or moved.
- The product does not operate even though the Switch is turned on.

**If any of the above occurs, unplug the product immediately and return to the store where you purchased it for check-ups and/or repairs.**

**This appliance is not intended for use by persons (including children) with reduced physical, sensory or mental capabilities, or lack of experience and knowledge, unless they have been given supervision or instruction concerning use of the appliance by a person responsible for their safety. Children should be supervised to ensure that they do not play with the appliance.**

- The illustration used in this Operating Instructions may vary from the actual product you have purchased.
- Keep this Operating Instructions readily available for users to easily refer to at any time.

## CAUTIONS

**Do not touch hot surfaces during or immediately after use.**

- Touching hot surfaces may cause burns.

**Do not place or use the product on unstable surfaces or on surfaces that are vulnerable to heat.**

- Doing so may cause fire.

**Do not remove the Glass Jug while brewing.**

- It may cause scalding.

**Do not use the product near walls or furniture.**

- Steam or heat may damage, discolor or deform walls or furniture.

**Do not move the product when the Glass Jug is in place.**

- It may cause scalding or other injuries.

**Unplug the Power Plug from the outlet when the product is not in use.**

- Leaving the Power Plug in an outlet may cause the insulation to become damaged, resulting in electric shock, short circuit or fire, or result in injuries or scalds.

**Please allow the product to cool down before cleaning.**

- Contacting hot parts may cause burns.

**Always unplug the product by holding the Power Plug, not by pulling the Power Cord.**

- Pulling the Power Cord to unplug the product may cause electric shock, short circuit or fire.

**If the Power Cord is damaged, it must be replaced by the manufacturer, its service agent or similarly qualified persons to avoid hazards.**

## IMPORTANT

**Do not fill the Water Tank with other than water, such as milk, alcohol, coffee, or hot water.**

- It may cause malfunction.

**Do not drop the Glass Jug or hit it against a hard surface or object.**

- It may break the glass and hurt you.

**Do not place the Glass Jug on top of direct fire or in a microwave.**

- The Glass Jug may break, the Handle may deform or sparks may come out from the metal parts.

**To brew coffee consecutively, turn off the switch (the Operation Lamp goes off) and wait at least 5 minutes.**

- Be careful when adding water or moving the product while it is still hot as steam or hot water may come out from the Purifying Filter and may cause scalding.

**Do not use or place the product on wet surfaces.**

- Doing so may cause electric shock.

**Do not operate the product without filling the Water Tank with water (except during Keep Warm mode).**

- It may cause malfunction.

**Do not use the product where its steam may come into contact with other electrical appliances.**

- The steam may cause fire, malfunction, discoloration or deformation to other electrical appliances.

**Do not soak the Glass Jug in water, splash it with water or place it on a wet surface while it is still hot.**

- If the Glass Jug is damaged, it could easily break. When it is broken, please be careful not to cut your hands with broken glass.

**This appliance is intended for household use and similar applications listed below:**

- Staff (employee) kitchen areas in shops, offices and other working environments.
- ✳ This appliance is not intended for use by many unspecified people for a long period of time.

**This appliance must not be used in the following areas:**

- Farm houses.
- By clients in hotels, motels and other residential type environments.
- Bed and breakfast type environments.



# PARTS NAMES

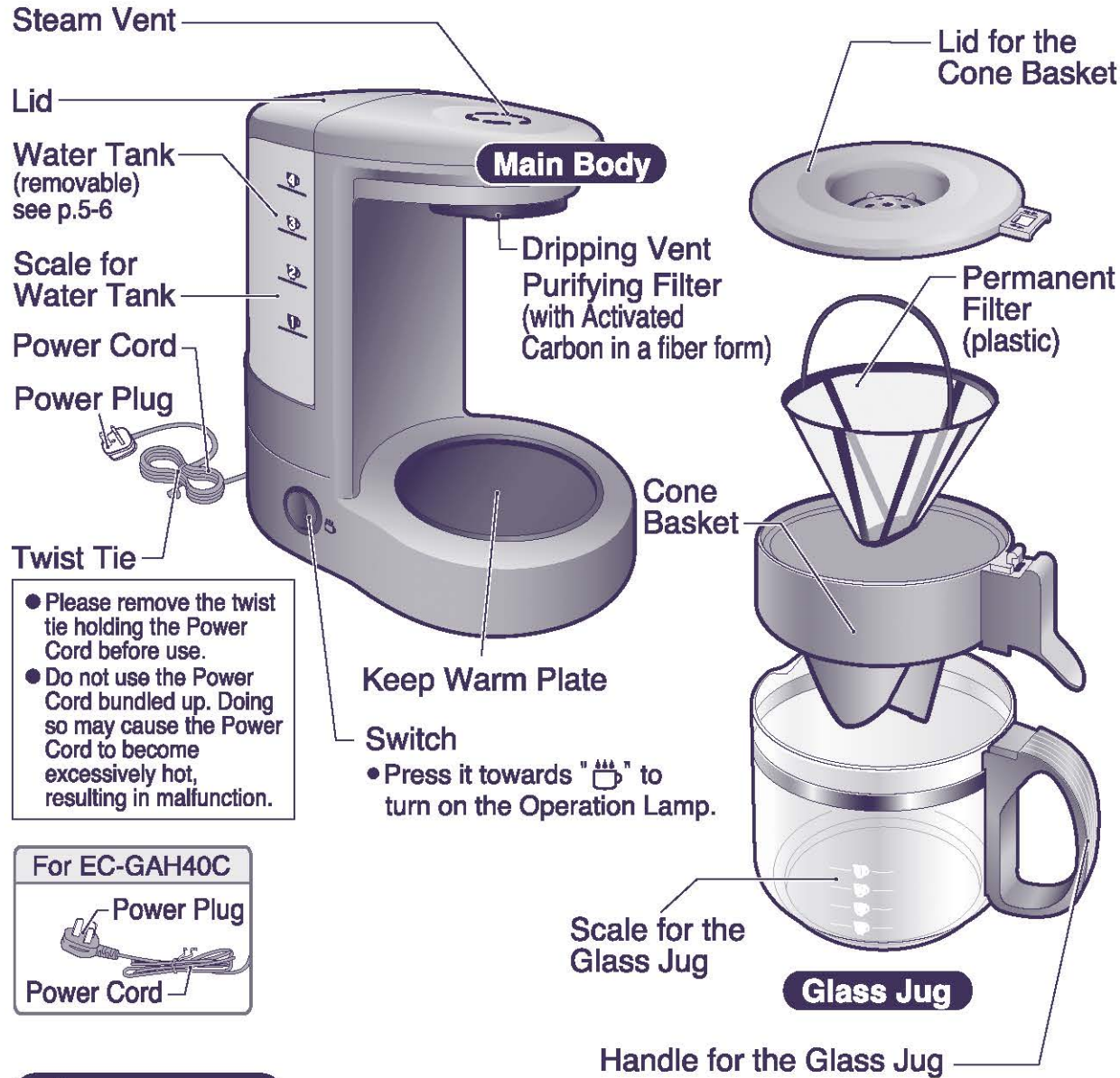

- Please remove the twist tie holding the Power Cord before use.
- Do not use the Power Cord bundled up. Doing so may cause the Power Cord to become excessively hot, resulting in malfunction.



**Accessory:**

- **Measuring Spoon (level off when measuring)**

For Coffee (approx. 7g)

**How to fold a Paper Filter**

Purchase the paper filter type (1x2) or (102) as a replacement.

① Fold the bottom    ② Fold the side    ③ Open up the filter

**About the Permanent Filter**

- Paper filter is not required when using the Permanent Filter at the same time.
- If the Permanent Filter is used, some fine coffee powder may be noticed in your coffee. If that matters, please use a Paper Filter.

# HOW TO USE HOW TO BREW COFFEE

- This is for household use only and not for commercial use.
- This product is for making coffee only. **Do not use this for other purposes.** Do not fill the Water Tank with other than water, such as milk, alcohol, coffee, or hot water as it may cause malfunction.
- At initial use and after some time of use, wash the Purifying Filter, the Glass Jug and the Cone Basket well, then operate the product once or twice with water only (do not make coffee) to clean it through.
- At initial use, you may smell plastic but it will fade away with use. You may also find some small black substances in your coffee, but this is the activated carbon from the Purifying Filter, and is harmless to your health.

## 1 Add Ground Coffee.

- ① Set the Cone Basket on the Glass Jug.
- ② Set the Permanent Filter (or Paper Filter) in the Cone Basket.
- ③ Measure ground coffee with the provided Measuring Spoon.
- ④ Follow the illustration below to set the Lid on the Cone Basket.



**Lid for the Cone Basket**

①

②

**Cone Basket**

Hook the hole ① to the projected part of ② and slide it towards the arrow in the illustration. To remove the Lid, slide it to the opposite direction of the arrow.

- Do not use Fine Grind coffee as the Permanent Filter (or Paper Filter) may clog and the coffee may overflow.

### Standard Guideline

Serving(s) Measurement of the ground coffee

Coffee Cup(s)	Level off the Measuring Spoon
4 Cups	4 Spoons (about 28g)
3 Cups	3 Spoons (about 21g)
2 Cups	2 Spoons (about 14g)
1 Cup	1 Spoon (about 7g)

## 2 Add water in the Water Tank.

- ① Remove the Water Tank from the Main Body.
  - Hold the Main Body and remove the Water Tank, or the Main Body will be lifted and may drop. (Do not touch the Steam Vent)
- ② Depending on the desired amount of coffee, add water using the scale on the Water Tank, and then cover the Lid.

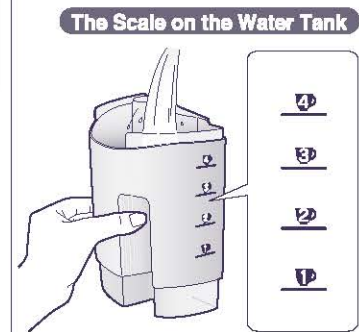
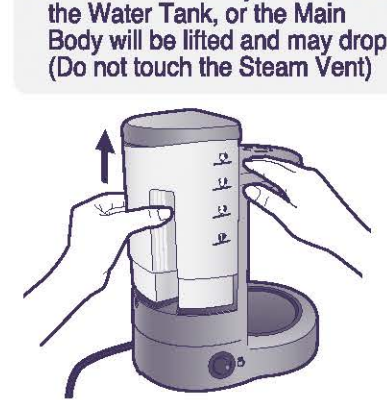

- Do not add more water than scale 4 on the Water Tank; otherwise coffee may overflow the Glass Jug.
- Do not fill the Water Tank with hot water as it may deform, or water may splash from the Dripping Vent.
- The scale on the Glass Jug shows the estimated amount of water to add in the Water Tank.



# HOW TO USE (cont.)

## 3 Set the Water Tank and the Glass Jug to the Main Body.

- ① Set the Water Tank to the Main Body securely.
  - ② Place the Glass Jug prepared 1 on the Keep Warm Plate.
- Set the Hole of the Water Tank to the Projected Part of the Main Body securely, or hot water may not come out when brewing.

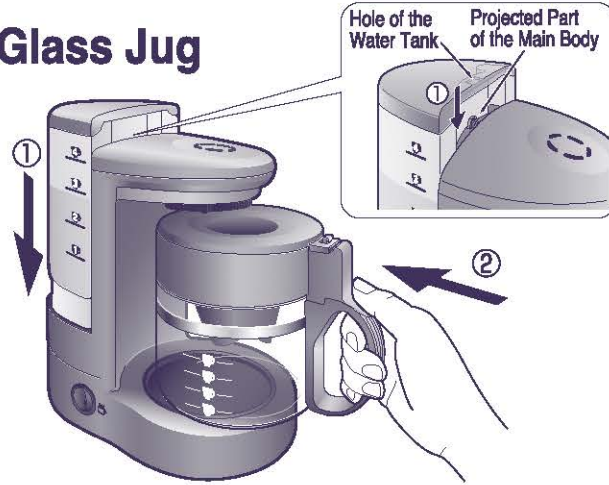

## 4 Plug in the Power Plug into the outlet, and then turn on the Switch.

The Switch light turns on and brewing starts.

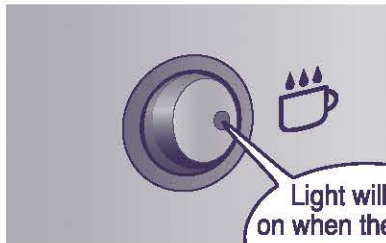

- Be sure that the Purifying Filter is set on the Main Body before brewing. Otherwise hot water may splash while brewing.
- Do not use the product where it can get wet as it may cause an electrical shock.

### Estimated Time of Completion:

Cups	1Cup	2Cups	3Cups	4Cups
Estimated Time (Approx.)	3min.	4min.	5min.	6min.

(based on water and room temperature of 20°C)

- The estimated time of completion may vary depending on the amount of water, water temperature and voltage.

## 5 When brewing completes, turn off the Switch and serve coffee.

- ① When brewing completes, turn off the switch (Light goes off).
- ② Be sure that there is no more hot water coming out from the Purifying Filter, then remove the Glass Jug to pour the coffee.

- Do not remove the Glass Jug until the Coffee Maker completes brewing. When the Glass Jug is removed during brewing, hot water may come out from the Purifying Filter and cause scalding.
- You can pour coffee with the Cone Basket on the Glass Jug.
- Be sure not to tilt the Glass Jug too much as the Cone Basket and the Lid may come off.



## 6 Unplug the Power Plug from the outlet.

- Be sure to hold the Power Plug when unplugging the Power Cord.

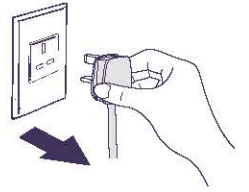

### How to Stop Brewing in the Middle of the Process:

- ① Turn off the switch (the Operation Lamp goes off) and unplug the Power Plug from the electrical outlet.
- ② Be sure that there is no more hot water coming out from the Purifying Filter, then remove the Glass Jug, the Cone Basket and the Lid.
- ③ After the Keep Warm Plate has cooled down, remove the Water Tank and empty the water.

### To Continue the Keep Warm Mode:

- ① Keep the Switch at the "☕" position.
  - ② Keep the Glass Jug on the Keep Warm Plate with the Lid on.
- Try to limit the length of Keep Warm to 15 minutes max to maintain the good aroma and flavor of the coffee.

### To Have Tasty Hot Coffee:

- Preheat the coffee cup(s) with hot water, then pour the freshly brewed coffee.
- Leave the Glass Jug on the Keep Warm Plate when brewing completes. (Try to limit the length of Keep Warm to 15 minutes max.)

### How to Brew Coffee Consecutively:

- Turn off the switch (the Operation Lamp goes off) and wait at least 5 minutes. (Please refer to "HOW TO USE" 1 )
- Do not move the Coffee Maker while it is hot as steam and hot water may suddenly come out from the Purifying Filter and cause scalding.



# CLEANING AND MAINTENANCE

- Do not splash the Main Body, Power Cord and Power Plug with water or immerse them in water.
- Do not wash or dry the product or parts in a Dishwasher or Dryer as they may deform.
- Do not use hot water to wash the product or parts as they may deform or break.
- Do not use abrasive cleaners and brushes (nylon/metal), as they may damage the surface.
- Do not use a thinner, benzene, bleach or detergents other than for kitchen.

<b>Main Body</b>	<ol style="list-style-type: none"> <li>① Wipe it clean with a well-wrung soft cloth with kitchen detergent.</li> <li>② Wipe with a well-wrung damp cloth.</li> <li>③ Wipe off any moisture with a dry soft cloth.</li> </ol>
<b>Purifying Filter</b>	<p>Rinse it with running water and dry it well.</p> <ul style="list-style-type: none"> <li>● Do not use any detergent to wash it.</li> <li>● The Purifying Filter is expendable and it is recommended to replace it with a new filter every 2 years, although that depends on the water quality and usage. (Calculation is based on the usage of one time per everyday.)</li> </ul>
<b>Water Tank Lid Cone Basket Lid Lid for the Cone Basket Glass Jug Permanent Filter (plastic)</b>	<ol style="list-style-type: none"> <li>① Wash it clean with diluted kitchen detergent.</li> <li>② Rinse with water.</li> <li>③ Wipe off any moisture with a dry cloth.</li> </ol> <ul style="list-style-type: none"> <li>● Do not use detergents other than for kitchen.</li> <li>● Drain moisture well from the Cone Basket and the Lid for the Cone Basket, or water may drip while brewing and when pouring coffee.</li> </ul>
<b>Power Cord and Power Plug</b>	Wipe with a soft dry cloth.

## About Purifying Filter. The Purifying Filter reduces the odor and dechlorinates by filtering the boiled water.

- During use, the Purifying Filter may discolor and turn brown depending on the quality of water. This is normal and is not harmful to your health.
- The illustration is the view from the bottom.

### ■ HOW TO DETACH:

Turn the Purifying Filter anti-clockwise as arrowed.

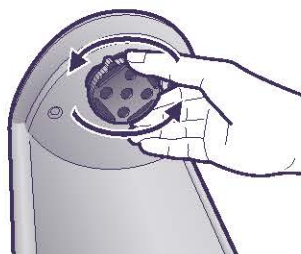

Perform it after draining hot water completely and after cooled down. (Otherwise it may cause scalding)

### ■ HOW TO ATTACH:

Set the Projected Part of the Purifying Filter to the Hole of the Main Body, and then turn clockwise as arrowed.



Be sure to turn to the end and stabilize the filter.

- Unplug the product from the outlet and allow the Main Body and the Keep Warm Plate to cool down before cleaning.

## When hot water does not come out from the Dripping Vent smoothly, clean with Citric Acid.

With use of the Coffee Maker, minerals contained in water may accumulate inside the pipes.

These are called "lime scale" and if they accumulate, the water may not drip smoothly, the amount of brewed coffee may be less, or the Purifying Filter may become clogged.

To remove the lime scale, please follow "How to Perform Citric Acid Cleaning" (Refer to the following.)

- The amount of lime scale formation varies as it depends on the water type and its quality. More lime scale may accumulate with the use of mineral-rich water.

## How to Perform Citric Acid Cleaning.

### ● Be sure to remove the Purifying Filter before cleaning.

Performing the citric acid cleaning while the filter is attached, the smell of citric acid may be absorbed by the filter or may cause to have a different taste of the coffee.

### ● Purchase the citric acid for cleaning at authorized Zojirushi stores. (It is sold separate from the product.)

Citric acid (100%) is used as one of the food additives and is harmless to your health, but do not eat it.

See pg.10 for the name of the replacement parts and the parts number.

- ① Add one teaspoon of citric acid (approx. 4g) to the Glass Jug.
- ② Add water to the scale 4 on the Glass Jug, then stir well to mix the citric acid with water.
- ③ Pour the citric acid water to the Water Tank and cover the Lid.
- ④ Set the Glass Jug (having set the Cone Basket and the Lid for the Cone Basket) and the Water Tank to the Main Body and turn on the Switch to start brewing.
- ⑤ Turn off the Switch when the water level reaches 1 (one).
- ⑥ After the liquid with the citric acid has cooled down, remove the scale floating in the liquid and pour the liquid back to the Water Tank and repeat procedure ④-⑤.
- ⑦ After the Keep Warm Plate has cooled down, empty the Water Tank, and repeat the brewing process (rinse process) with only water a few times.



# TROUBLESHOOTING GUIDE

Please check the following points before calling for service.

Condition	Cause	Remedy
The product does not operate although the switch is turned to "☕".	Is the Power Plug plugged in correctly?	Plug the Power Plug into the outlet.
Hot water does not come out.	Is the Water Tank filled with water?	Add water to the Water Tank.
	Is the Water Tank set correctly?	Set the Water Tank correctly.

## REPLACEMENT PARTS

- Replacement parts may be available for an additional charge. Please replace damaged parts only with new parts.
- When replacing parts, please record the model number and part name beforehand. Then contact the store where you purchased the product.
- Glass Jug (sold as a replacement part) does not include the Cone Basket and Lid for the Cone Basket.
- The plastic color of the replacement Glass Jug's Handle is slightly different from that of the Main Body.

Part Name	Part Number
Purifying Filter for Coffee Maker	EC-F01
Glass Jug for Coffee Maker	JAGECTBF
Measuring Spoon for Coffee Maker	7172500002-01
Inner Container Cleaner for Electric Pots (citric acid)	CD-K03E

## SPECIFICATIONS

<b>Model No.</b>	EC-GAQ40	EC-GAH40C
<b>Rating:</b>	AC220—230V 50/60Hz	AC220V 50Hz
<b>Electric Consumption:</b>	600—650W	600W
<b>Capacity:</b>	Max. 540mL	
<b>Coffee Brewing System:</b>	Drip Type	
<b>Length of the Power Cord:</b>	1.3m (rubber material)	
<b>External Dimensions (approx. cm):</b>	21.5(W)x15(D)x23.5(H)	
<b>Weight:</b>	Approx. 1.4kg	

- External dimensions are the one without the handle of the Glass Jug.

### WARNING — THIS APPLIANCE MUST BE EARTHED

⟨for EC-GAQ40 only⟩

#### IMPORTANT

The wires in this mains lead are coloured in accordance with the following code:

Green-and-yellow:Earth Brown:Live Blue:Neutral

If the colours of the wires in the mains lead of this appliance do not correspond with the coloured markings identifying the terminals in your plug, proceed as follows.

The wire which is coloured green-and-yellow must be connected to the terminal in the plug which is marked with the letter E or by the earth symbol or coloured green or green-and-yellow. The wire which is coloured blue must be connected to the terminal which is marked with the letter N or coloured BLACK.

The wire which is coloured brown must be connected to the terminal which is marked with the letter L or coloured RED.

This appliance must be protected by a 13A fuse if a 13A (BS1363) plug is used or, if any other type of plug is used, by a 10A fuse either in the plug or adaptor or at the distribution board.

GREEN AND YELLOW 13 AMP FUSE

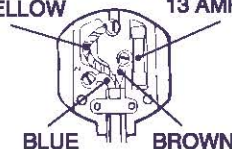



# 咖啡机 使用说明书

## EC-GAH40C / EC-GAQ40

感谢您购买本产品。

请在使用前详读使用说明书，以便能正确使用，并请妥善保管本说明书。

### 目录

安全注意事项	2
各部分名称	4
使用方法	5
清理	8
柠檬酸清洗方法	9
认为故障时	10
关于零件更换	10
规格	10



# 安全注意事项

务请遵守

为了防止给使用者或他人带来危害、财产损失，务请遵守以下注意事项。

■将操作有误时造成的各种危险或伤害的程度按以下的划分予以说明。



**警告**

可能会导致死亡或重伤的内容。



**注意**

可能会导致轻伤或住房、家财等损害的内容。

■务请遵守的内容，按以下的划分予以说明。



不得进行的“禁止”内容。



务必实行的“指示”内容。



**警告**



不得改造。除了修理技术人员以外，不得拆卸或擅自修理。

否则，会导致火灾、触电、受伤。  
需要修理时，请惠询本公司指定的服务中心。



不得浸泡于水中、不得溅水。

否则，有造成短路、触电的危险。



不得用湿手插拔插头。

否则，有可能导致触电、受伤。



不得用手和脸接触或靠近蒸气口。

否则，会导致烫伤。  
尤其应防止幼儿触摸。



不得让儿童单独使用，不得在幼儿摸得到的地方使用。

否则，有造成烫伤、触电、受伤的危险。

不得使用交流220V (EC-GAH40C)，220-230V (EC-GAQ40) 以外的电源。

否则，会导致火灾、触电。

不得在无玻璃壶状态下使用。

否则，有造成烫伤的危险。

电源线、插头损伤时或插座松动时，请勿使用。

否则，会导致触电、短路、起火。

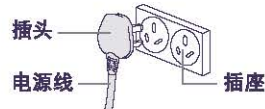

电源线不得受损。

强行扭曲、拉扯、扭转、捆扎、或靠近高温处，电源线上放置重物，或挤压、加工，会造成电源线破损，而有引起火灾或触电的危险。



将插头完全插入插座。

否则，会导致触电、短路、冒烟、起火。

应单独使用额定10A以上的插座。

若与其他器具共同使用，分路插座部分会因异常发热而引起火花。

插头前端及插脚插入面有灰尘沾附时，应仔细擦拭。

否则，有引起火灾的危险。

发生异常、故障时，请立即停止使用。

如照常使用则可能导致冒烟、起火、触电、受伤。

<异常情况、故障示例>

- 电源插头、电源线异常发热
- 电源线有严重损伤或变形
- 有焦糊味
- 本体的部份破损、松动或晃动
- 如触动电源线，则时而通电时而断电
- 插入插头后仍然无法启动

发生上述情况时，请立即拔掉电源插头，必须委托经销店进行检查、修理。

在没有安全责任人对本机器的使用给予指挥管理或指示的情况下，运动能力、感觉能力或是智力低下及缺乏经验和知识的人（包括儿童）严禁使用本机器。家长应照看管理好孩子，避免儿童用本机器玩耍。



**注意**



在使用中或刚使用后，不要碰触高温部。否则，会导致烫伤、受伤。



不使用时，请从插座上拔下插头。

否则，会导致受伤、烫伤，或因绝缘劣化而引起的触电、漏电、火灾。



请勿在不稳定的地方或不耐热的垫子上使用。

否则，会导致火灾。



待机体冷却后再进行清理。

否则，碰触到高温部会有造成烫伤的危险。

在煮制咖啡时不要取出玻璃壶。

否则，会导致烫伤。

拔下插头时，务必手持插头，不得拉扯电源线。

否则，会导致触电、短路、起火。

不要在距离墙壁、家具过近的地方使用。

否则，会造成墙壁或家具变色或变形。

不要移动装有玻璃壶的机体。

否则，会导致烫伤、受伤。

电源线破损时，请制造商或其经销商或具备资格的技术人员前来更换电源线。

**敬请注意**

■水箱内请勿加入水以外的液体。

水箱内如加入牛奶、酒、咖啡、开水等会造成故障。

■请勿空烧。

除保温之外，在水箱无水状态下通电时，会造成故障。

■请勿摔落、也不要使用硬物撞击玻璃壶。

否则，一旦玻璃破碎会导致受伤。

■请勿在蒸气会喷到其他电器的地方使用。

否则，会因蒸气喷出导致电器的火灾、故障、变色及变形。

■请勿直接用火、或使用微波炉加热玻璃壶。

否则，会造成玻璃破裂、把手变形、或金属部位起火花。

■请勿将玻璃壶尚未冷却时就放入水中或用水淋浇、也不要放置在潮湿之处。

否则，会造成伤痕容易破裂。一旦玻璃壶破碎，请在清除时格外小心不要割破手。

■连续煮制咖啡时，请关闭电源（指示灯灭灯），再等待5分钟以上。

在机体尚未冷却时就加水或移动，可能会从净水过滤器中突然冒出蒸气或流出热水而导致烫伤。

■本产品用于一般家庭以及以下类似用途。

●可用于商店、办公室或其他工作环境中的员工用厨房。

※但是，不要用于因未指定人群造成的长时间使用。另外，也不要用于以下的类似用途。

●宾馆、汽车旅馆、其他住宿设施等。

■请勿在被水淋湿的地方使用。

否则，会导致触电。

- 所购商品与本说明书的插图可能会有不同。
- 阅读后，请保管在使用者随时都可看到的地方。



# 各部分名称

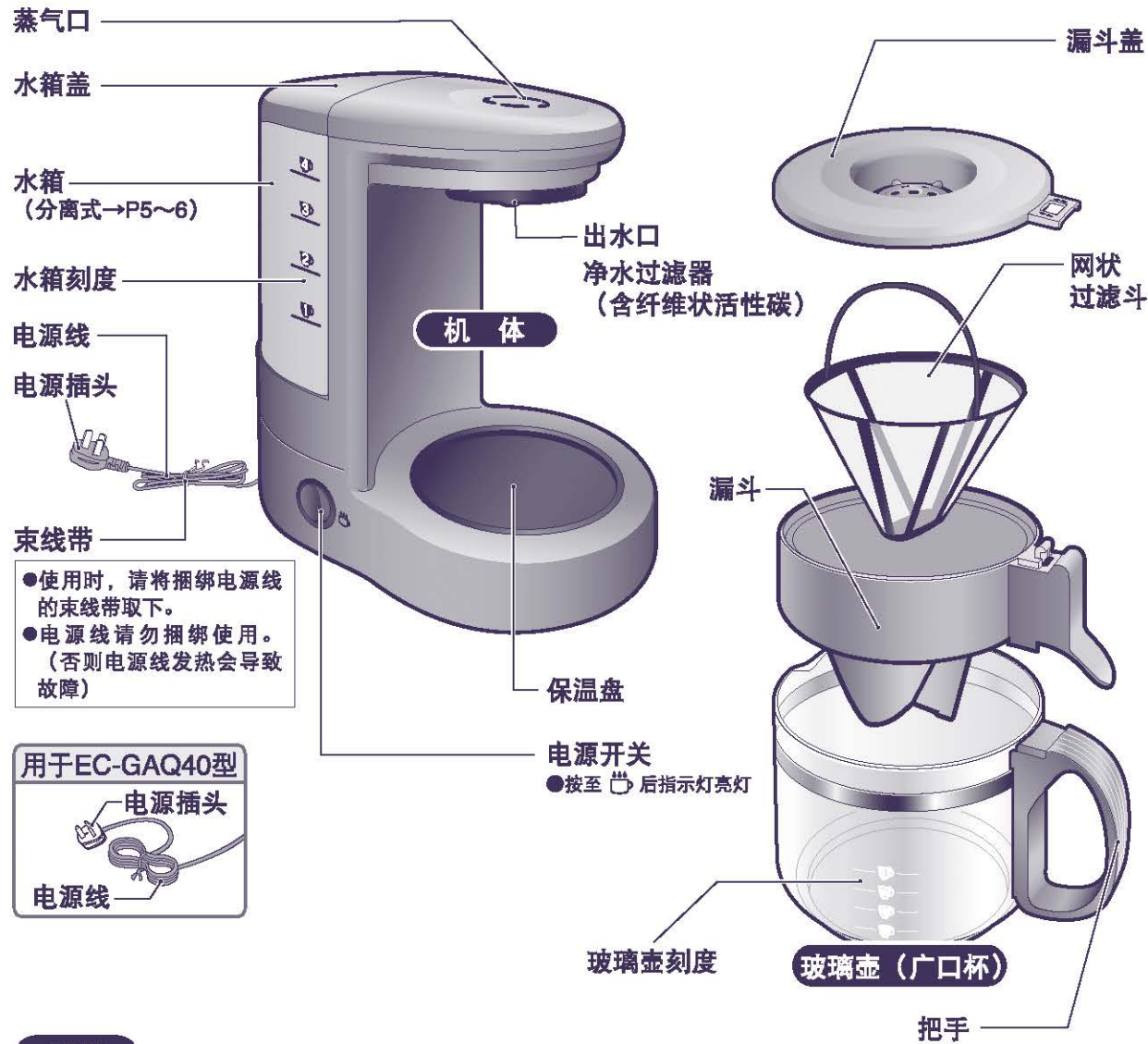

●使用时，请将捆绑电源线的束线带取下。  
●电源线请勿捆绑使用。（否则电源线发热会导致故障）



## 附件

●量匙  
(平口盛满1勺)



## 滤纸的折叠方法

滤纸用完时，请购买商店内出售的(1×2)或(102)滤纸。



## 关于网状过滤斗

●没有必要同时使用网状过滤斗和滤纸。  
●使用网状过滤斗滴滤时，咖啡粉末可能会混入咖啡中，如果您在意的话，请使用滤纸进行滴滤。

# 使用方法 滴滤

- 本产品是家用产品。请勿用于商业用途。
- 本产品是用于煮制咖啡的器具。请勿用于煮制咖啡以外的用途。水箱内如加入牛奶、酒、咖啡、开水等会造成故障。
- 初次使用和长时间未使用时，请清洗净水过滤器、玻璃壶及漏斗等，并用清水滴滤1-2次。
- 刚开始使用时可能会有些塑料异味等，但随使用次数增加异味会逐渐消失。另外，在初次使用时可能会有黑色粉末落下，这是净水用的无害活性炭，并不妨碍器具的使用。

## 1 放入咖啡粉

- ①将漏斗放入玻璃壶。
- ②再将网状过滤斗(或滤纸)放入漏斗内。
- ③用量匙将咖啡粉倒入网状过滤斗(或滤纸)中。
- ④如下图所示，盖上漏斗盖。



●请勿使用细研磨的咖啡粉。否则，可能会堵塞网状过滤斗(或滤纸)，造成咖啡溢出。

## 标准使用量

	咖啡杯数	咖啡粉量 量匙(平口盛满)
咖啡杯	4杯	4匙(约28g)
	3杯	3匙(约21g)
	2杯	2匙(约14g)
	1杯	1匙(约7g)

## 2 将水加入水箱

- ①从机体中取出水箱
- ②根据煮制咖啡的用量加水至刻度线，然后盖上水箱盖。

●请按住机体取出水箱，否则机体有可能会被带起造成掉落。(请勿用手触摸蒸气口)

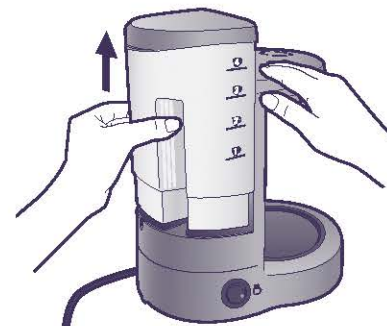

●加水时请注意不要超过水箱的刻度线“4”。否则，会造成咖啡从玻璃壶中溢出。  
●请勿加入开水。否则，会造成水箱变形或热水溅出。  
●玻璃壶刻度是表示加入水箱的水量参考值。



# 使用方法 续

## 3 将水箱和玻璃壶装到机体上

- ①将水箱完全装到机体底部。
- ②再将由1准备好的玻璃壶放到保温盘上。

- 请将水箱的孔部确实装到机体的凸部  
如果没有完全装好，有可能会在滴滤中不出热水。

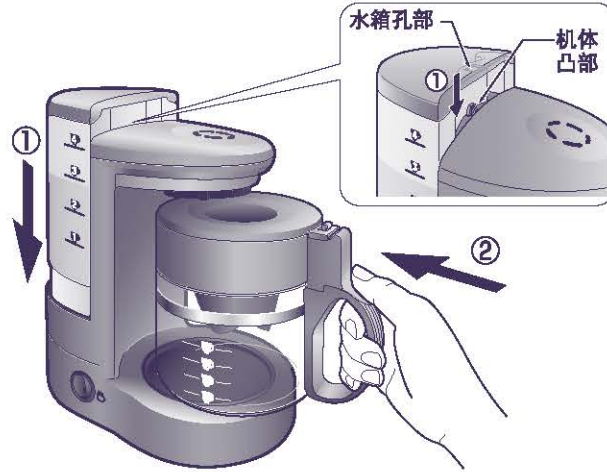

## 4 将电源插头插入插座 打开电源

电源灯亮灯，开始滴滤。

电源开关按至后指示灯亮灯。

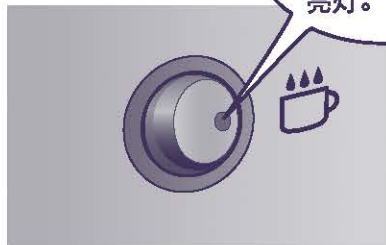

- 在滴滤之前，请确认是否已将净水过滤器安装于机体上，如未安装净水过滤器，在滴滤中可能会造成热水飞溅。
- 请勿将机体放置在被水淋湿的地方使用，否则，会导致触电。

咖啡煮好的大致时间 (水温、室温约20℃)

杯数	1杯	2杯	3杯	4杯
咖啡杯数 (约)	3分钟	4分钟	5分钟	6分钟

- 咖啡煮好时间因水量、水温、电压等不同。

## 5 滴滤结束 关闭电源、倒出咖啡

- ①咖啡煮好后，关闭电源。
- ②确认净水过滤器已不再流出热水后，取出玻璃壶，将咖啡倒入杯中。

- 不取出玻璃壶中的漏斗，也可将咖啡倒入杯中。
- 过于倾斜倒咖啡时，漏斗和漏斗盖可能会掉下，故请注意。
- 请待水箱内无水后再取出玻璃壶。中途取出时，可能会从净水过滤器中流出热水而造成烫伤。

将咖啡倒入杯中时，漏斗盖内积留的水滴，可能会从漏斗与漏斗盖之间的缝隙中流出，故请注意。



## 6 将电源插头从插座拔下

- 务必手持插头从插座拔下插头。

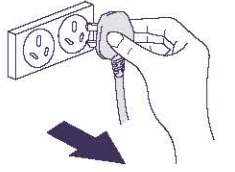

### ■中途停止煮制时...

- ①关闭电源，从插座拔下插头。
- ②确认净水过滤器已不再流出热水后，取出玻璃壶、漏斗及漏斗盖。
- ③待保温盘冷却后取出水箱，再将剩余水倒净。

### ■持续保温时...

- ①将电源开关按至.
  - ②将漏斗盖盖在玻璃壶上进行保温。
- 长时间保温，会使咖啡香味消失、口味变差，故保温时间请在15分钟以内。

### ■喜好享用热咖啡时...

- 请预先用热水将咖啡杯烫热后再倒入咖啡。
- 咖啡煮好后，请将玻璃壶放置在保温盘上保温。(保温时间请在15分钟以内。)

### ■连续煮制咖啡时...

- 关闭电源，待机体冷却5分钟以上，再按照“使用方法”中1进行煮制。
- 机体尚未冷却时，请不要加水或移动。否则，可能会从净水过滤器中突然冒出蒸气或流出热水，造成烫伤。



# 清理

请务必拔下插头，待机体和保温盘冷却后进行。

- 请不要将水淋浇到机体、电源线、电源插头，也不要将咖啡机整体清洗。（会造成触电及故障）
- 请不要使用去污粉、海绵块的尼龙面、金属刷及尼龙刷等进行清洗。（会造成表面损伤）
- 请不要使用餐具洗涤剂或餐具烘干机进行清洗及烘干。（会造成零件变形。）
- 请不要使用厨房专用中性洗涤剂以外的洗涤剂，不要使用信那水、汽油、漂白剂等。
- 请不要使用热水清洗。（会造成变形及破损。）

机 体	<ol style="list-style-type: none"> <li>①用软布沾上稀释后的厨房用中性洗涤剂、拧干后擦拭污垢。</li> <li>②再用拧干水分的布仔细擦拭。</li> <li>③最后用干软布将水分擦干。</li> </ol>
净水过滤器	<p>用水冲洗后充分晾干</p> <ul style="list-style-type: none"> <li>● 请不要使用洗涤剂。</li> </ul> <p>● 净水过滤器是消耗品。堵塞时请进行更换（收费）。因水质和使用方法的不同，大致约每2年更换1次。（以每天使用1次为准）</p>
水箱 水箱盖 漏斗 漏斗盖 玻璃壶 网状过滤斗	<ol style="list-style-type: none"> <li>①用稀释的厨房用中性洗涤剂清洗。</li> <li>②再用水洗净。</li> <li>③最后用干布将水分完全擦干。</li> </ol> <ul style="list-style-type: none"> <li>● 除厨房用中性洗涤剂以外，请勿使用其他洗涤剂等。</li> <li>● 请擦净漏斗及漏斗盖的水分。否则在滴滤中或在倒入咖啡时，可能会有水滴流出。</li> </ul>
电源线 电源插头	用干软布擦拭

## 关于净水过滤器

开水通过净水过滤器流出，可减少漂白粉味。

- 净水过滤器可能会因水质等原因而变色（茶色），但并不影响使用。
- 下图为底部视图。

### 取下方法

将净水过滤器往箭头方向拧转后取下。

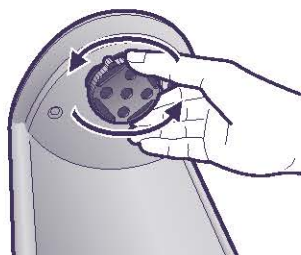

将热水清除干净，待机体完全冷却后在进行清理。（会造成烫伤）

### 装入方法

将净水过滤器的突出部对准机体的凹部，往箭头方向拧转。

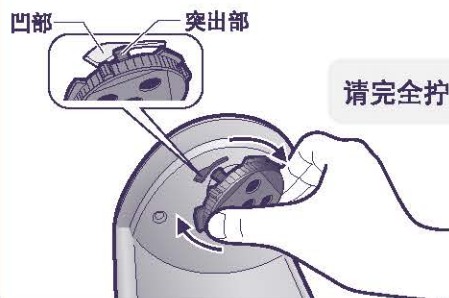

请完全拧紧固定。

## 当热水流出不畅时，请进行柠檬酸清洗。

咖啡机在使用过程中，水中所含的矿物质会附着在咖啡机内的水管上，这就是通常所说的“水垢”，一旦水垢附着，会使出水变得不畅；咖啡的滤出量减少；净水过滤器容易堵塞。故请按下述的方法去除水垢。

- 水垢附着程度因水质而异。矿物质含量多的水质（矿泉水等）容易附着水垢。

## 柠檬酸清洗方法

- 在清洗前，请务必先取下净水过滤器。如不取下净水过滤器直接清洗，会因柠檬酸的残留味而影响咖啡的香味。

- ①在玻璃壶中放入1小匙柠檬酸（约4g）
- ②加水至玻璃壶刻度4，然后充分搅拌使柠檬酸完全溶于水中
- ③再将柠檬酸溶液倒入水箱，盖上水箱盖
- ④将玻璃壶（装入漏斗和漏斗盖）、水箱放到机体上，进行滴滤
- ⑤当柠檬酸溶液减少至水箱刻度“1”时，关闭电源
- ⑥待经过滴滤的柠檬酸溶液冷却后，除去溶液中的混杂物（白色结晶等），再将溶液倒入水箱，重复④~⑤的操作

- 清洗用柠檬酸请到象印商品经销店购买。（另售）  
柠檬酸（100%）作为食品添加剂使用，虽在食品卫生上无害，但请勿饮用。

零件名称和号码请参阅P10的关于零件更换。

- ⑦待保温盘充分冷却后，将玻璃壶中及水箱内的柠檬酸溶液倒净、并进行冲洗，然后使用清水滴滤数次



# 认为故障时

在致电要求服务前请检查以下列出的几点。

现象	原因	解决方法
即使将电源开关按至  也不通电。	电源插头是否从插座上脱落？	请将电源插头完全插入插座。
不出热水。	水箱内是否已加入了水？	请在水箱内加入水。
	是否正确装入水箱？	请正确安装水箱。

## 关于零件更换

- 下表为更换零件的名称。损坏时，请更换新的零件（收费）。
- 更换时，请确认好产品的型号及零件名称后，去经销店购买更换。
- 玻璃壶（广口杯）不附带漏斗及漏斗盖。
- 玻璃壶（广口杯）把手的颜色与本产品的颜色略有不同。

零件名称	零件号码
咖啡机用净水过滤器	EC-F01
咖啡机用玻璃壶（广口杯）	JAGECTBF
咖啡机用量匙	7172500002-01
热水瓶内容器清洗用柠檬酸	CD-K03E

## 规格

型号	EC-GAH40C	EC-GAQ40
电源	交流220V 50Hz	交流220-230V 50/60Hz
消耗功率	600W	600-650W
容量	最大水容量 540mL	
方式	滴滤式	
电源线长度	约1.3m（橡胶软线）	
外形尺寸（约cm）	宽21.5×深15×高23.5	
重量	约1.4kg	

- 外形尺寸不包含玻璃壶把手。